

Dealer Name : _____
 Dealer Contact : _____
 Client Name : _____
 Scripting Date: ____/____/____
 Ship To : _____

 Dealer



Order N° _____ Quotation
 Date _____ Signature _____
 Customer Ref. _____
 Funding: _____
 Email Quote To : **PAGE 1/2**

 2020, January

Key standard option

CHILDREN 3000

CHILDREN 3000 24* 26* 28* 30 32 34 36
 L Seat width * Not available with detachable foot-rests

CHILDREN 3000 PLUS
 L Seat width (adjustable within the selected range) RANGE 1 24* 26* 28* 30 32 34
 RANGE 2 26* 28* 30 32 34 36 38
 * Not available with detachable foot-rests

P Seat depth 28 30 (adjustable from 28 to 34 cm)
 32 34 36 38 (adjustable from 32 to 38 cm)
 HS Back-rest height 25 27 29 31 33 35 37 39 41
 HA Front seat/floor height 40 42 44 46 48
 HP Rear seat/floor height 36 38 40 42 44 46
 DP Foot-rest/seat distance 17* 19* 21* 23 25 27 29 31 33
 35 37 39
 * Not available with detachable foot-rests

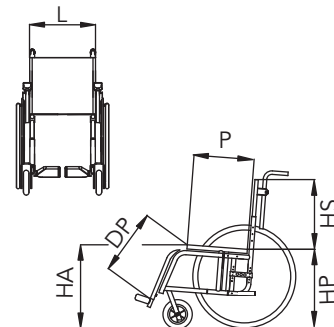

cm

Frame colour

- Metallic light blue Orange Pearl red Metallic pink
 Neon orange Neon green
 (see "Colour" catalogue)

①

Upholstery

- Tension adjustable nylon back-rest
 Tension adj. breathable b.
 Without back-rest
 Without seat

②

Upholstery colour (only nylon)

- Black Light blue
 Red Green
 Cornflower blue Orange

③

Front frame

- Standard (Not suggested for L < 32cm)
 Abducted

④

Foot-rest

- Detachable
 Not detachable
 Elevating (detachable)
 Subject to technical approval

⑤

Separate aluminium profile foot-plates

- Foot-holding belts

⑥

Single aluminium profile foot-plate

- Foot-holding belts

⑦

Side guards

- Plastic (standard) (Not available with reclining back-rest)
 Aluminium (curved, same colour)

⑧

Height adjustable "T" arm-rest

- Elbow-rest**
 Classic (23 cm long)
 Classic (30 cm long)
 Straight (26 cm long)

⑨

Standard pushing handles

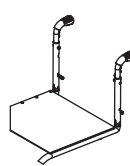

Straight height adjustable pushing handles

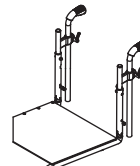

Abducted height adjustable pushing handles

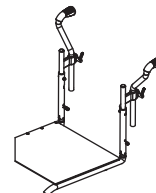

⑩

Rear wheels

- 24" Light (24 spokes) (*)
 22" Light (24 spokes)
 20" Light (20 spokes)

Tyres

- Pneum. high pressure smooth
 Pneum. high pressure plugged
 Solid
 Marathon Plus 22" or 24"

(*) Only with P = 34 or 36 cm and HP from 40 to 46 cm

⑪

Handrims

- Aluminium silver
 Chromium-plated steel
 Dark aluminium
 Rubber coated
 Carbolife CURVE L 24"
 Carbolife GEKKO 24"
 Silicon covers

⑫

Spoke guards

- Transparent
 Black
 Alphabet
 Fantasy
 code pattern:
 (see catalogue of spokeguards)

⑬

Front castors

- 80 (3") solid with lights
 80 (3") solid
 100 (4") solid with lights
 100 (4") solid
 100 (4") solid with alum. rim
 125 (5") solid
 125 (5") solid with lights
 125 (5") solid with alum. rim
 150 (6") pneumatic
 150 (6") solid

⑭

Rear wheel camber

- 1° 3° 5°

⑮



Dealer Name : _____
 Dealer Contact : _____
 Client Name : _____
 Scripting Date: ___/___/___
 Ship To : _____



Order N° _____ Quotation
 Date _____ Signature _____
 Customer Ref. _____

Funding: _____
 Email Quote To: **PAGE 2/2 CHILDREN 3000**
 2020, January

Dealer

Revolving anti-tip device

16

- Right
- Left
- Right and left

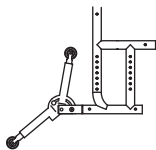

Extended wheel plate

17

Compulsory with reclining back-rest

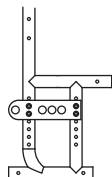

Lined cushion
 in foam polyurethane

18

- 3 cm high
- 5 cm high



Single drive
 (Only with 0° rear wheel camber)
 (Only with 22" or 24" wheels)

19

- Right
- Left

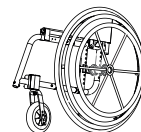

Head-rest
 Padded

20

- Fixed
- Height adjustable

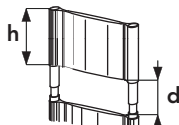

Moulded

- Fixed
- Height adjustable

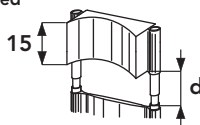

Orbital

- Moulded
- Anatomic

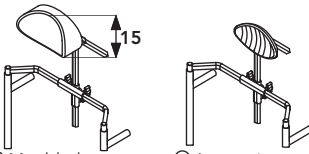

Specify "h" & "d" where requested
 Standard: h = 15 cm d = 10 cm

h = cm d = cm

Abductor

21

- 1 3 5 7 cm
- cm

Choose or specify the height from the seat cover

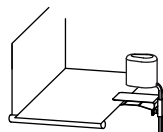

Lateral supports

22

- Right
- Left

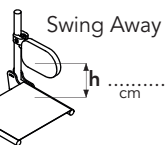

Specify the height "h"

Table

23

- Transparent
- Black soft padded

specify the fastening:
 single double



(Only with arm-rest)

Anodized set

24

(Rear wheel rim&hub and front fork)

- Black
- Silver
- Light blue
- Red
- Orange
- Cyclamen light purple

Brakes

25

- Classic - short handle
- Classic - pull to brake
- Classic - long handle
- Right single brake
- Left single brake
- Drum
- Drum + classic

Options

- 27 "M" & "F" velcro on seat
- 28 "M" velcro strip (hook) on seat
- 29 "F" velcro strip (loop) on seat
- 30 Label of connection seat/back-rest
- 31 Padded rigid seat
- 32 Chest harness
- 33 Chest belt
- 34 Abductor belt
- 35 Pump for pneumatics
- 36 Back anatomic board
- 37 45° pelvic belt
- 38 45° padded pelvic belt
- 39 Black backpack
- 40 Umbrella holder

Reclining back-rest

26

from 90° to 150°
 (compulsory:
 - straight or abducted height adjustable
 - pushing handles
 - stretched bar
 - extended wheel plate)

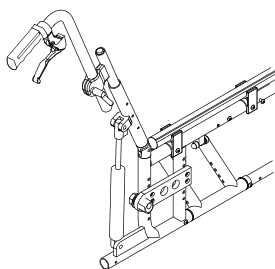

Notes

